

MR16 EXTERIOR 12V INGROUN UP LIGHTERS (small faceplates)



PRODUCT FEATURES

- Input voltage : 12-25V DC / AC
- External Control Gear Required
- Faceplate: 316 stainless steel or solid copper
- Housing: 316 stainless steel or solid copper
- Lamp holder: MR16 (Max 20W halogen globe)
- Globe not included
- Plastic sleeve included (must be used when installing in concrete)
- Fitting slides into sleeve and remains unattached
- Cable included (L950mm)



IGMEYEC



IGMEYESS

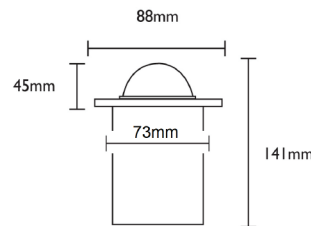

IGMEYEC, EYESS

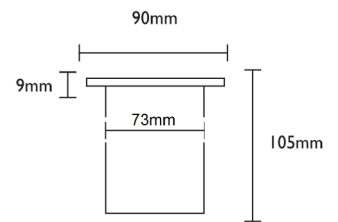

IGMSMC, IGMSMSS, IGMRSS



IGMSMC



IGMSMSS



IGMRSS

IGMEYEC	4mm Tempered Glass. Max load capacity 100Kg
IGMEYESS	4mm Tempered Glass. Max load capacity 100Kg
IGMSMC	4mm Tempered Glass. Max load capacity 600Kg
IGMSMSS	4mm Tempered Glass. Max load capacity 600Kg
IGMRSS	4mm Tempered Glass. Max load capacity 600Kg

PART NO.	DESCRIPTION	COLOUR	WEIGHT (KG)	BOX (CM)	CARTON QTY
IGMRSS	INGROUND / WALL Grilled MR16 12V SS316 RND	316 Stainless steel clear anodized	0.4	13 x 10 x 10	1/20
IGMEYEC	INGROUND / WALL EYELID MR16 12V COP RND	Polished copper	0.8	16 x 10 x 10	1/20
IGMEYESS	INGROUND / WALL EYELID MR16 12V SS316 RND	316 Stainless steel clear anodized	0.7	16 x 10 x 10	1/20
IGMSMC	INGROUND UPLIGHTER / OPEN WALL MR16 12V COP SM RND	Polished copper	0.4	13 x 10 x 10	1/20
IGMSMSS	INGROUND UPLIGHTER / OPEN WALL MR16 12V SS316 SM RND	316 Stainless steel clear anodized	0.4	13 x 10 x 10	1/20